

## FEATURES AND SPECIFICATIONS

### Features and Benefits

The Molex Premise Networks Surface Mount Box was designed specifically to accommodate the DataGate™ Jack. Supplied unloaded, the Surface Mount Box is easy to install on site. The box can be fitted using screws (not provided). Cable is installed from the underside and rear of the box. Critical cable bend radius measurements, crucial for Category 6 installations are easy to maintain due to the integral cable management provided.

- Rugged PC/ABS plastic
- Snap on Lid
- Protected labelling facility
- DataGate Jack is purchased separately

### Technical Information

Material:	PC/ABS ULVO rated.
Dimensions:	66mm (L) x 30mm (H) x 32mm (W).
Shipping Weight:	32 g.
Termination Tools	Industry Standard



## 1 Port Surface Mount Box Unloaded

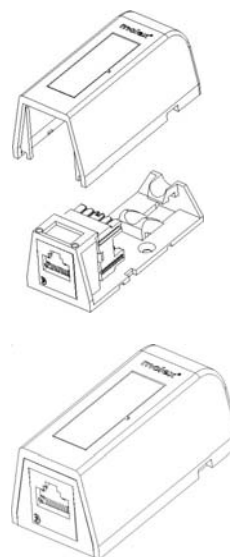

## ORDERING INFORMATION

Order No.	Description
SBX-00004-02	1 Port Surface Mount Box White

### DataGate Jack

Order No.	Description
KSJ-00001-XX	DataGate SE UTP 8W 568A/B Shuttered Jack
KSJ-00012-02	DataGate SE FTP 8W 568A/B Jack White, No Shutter
KSJ-00013-02	DataGate 6 UTP 8W 568A/B Shuttered Jack

DataGate Colour Options: FTP DataGate only available in White

Insert colour code in place of XX when ordering UTP DataGate Jacks

01 = Almond	RD = Red
02 = White	BL = Blue
04 = Black	GR = Green
08 = Light Grey	RG = Orange
	YL = Yellow
	PP = Purple

## MOLEX PREMISE NETWORKS

**Molex Premise Networks**  
Corporate Headquarters  
Tel: 1 866 733 6659  
www.molexpn.com

**European**  
Headquarters  
Tel: 44 (0) 1489 572111  
www.molexpn.co.uk

**Pac Rim**  
Headquarters  
Tel: 61 3 9971 7111  
www.molexpn.com.au

**Molex**  
Incorporated  
Tel: 630 969 4550  
www.molex.com