

FDV DOKUMENT

ipas™

Frisbee Mega 40W 3000K
32 173 36 / 233604

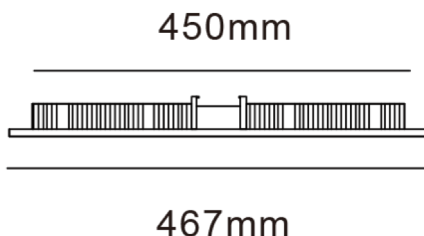

| Art nr | El nr | Produktnavn | Å | Lysytelse | DIM | System eff | CRI | Lys farge | IP | Farge |
|--------|-----------|------------------|------|-----------|-------|------------|-----|-----------|----|-------|
| 233604 | 32 173 36 | Frisbee Mega 40W | 120° | 3200 lm | Triac | 40W | >80 | 3000K | 20 | Hvit |

LUMENMAX LED

| | |
|--------------------------|--|
| Tekniske data: | 36W (System effekt 40W) |
| Spenning: | 220-240VAC 50/60Hz |
| LED Chip | Lumenmax SMD LED |
| Lysytelse: | 3200 lm |
| Lysfarge: | 3000K |
| CRI/Ra: | >80 |
| Strålingsvinkel: | 120° |
| Utbyttbar LED: | Nei |
| Driftsstrøm: | 950mA konstantstrøm |
| Dimming: | Dimbar GLE |
| Sertifisert: | CE |
| Omgivelsestemp: | -40°C +50°C |
| Materiale: | Die-casting aluminium |
| Farge: | Matt Hvit |
| IP Klasse: | IP20 |
| Isolasjonsklasse: | Klass II |
| Levetid: | 60 000 L80 |
| HulltakØ | Ø450mm |
| Produktstørrelse: | Ø467x15mm |
| Vekt: | 2,10 kgs |
| Antall per eske: | 1stk Dimensjon: 450x450x18mm Vekt: 2,30 kgs |
| Antall per ytterkartong: | 5stk Dimensjon: 520x520x350mm Vekt: 15,0 kgs |

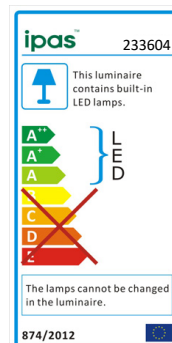

Rengjøring:

Planmessig rengjøring gir deg best belysning over tid.

Gjør anlegg alltid strømløst før rengjøring.

Det anbefales støvtørking med mikrofiber. Intervaller avhenger av bruksområdets støv-/smussmengde. Unngå sterke kjemikalier (ph>7) og vær varsom med frontlinse eller reflektor hvis denne er tilgjengelig. Ikke spray midler direkte på armatur. Særlig tilsmussede områder kan rengjøres med mildt såpevann, men prøv på et avgrenset område først. LED Driver eller åpne komponenter må ikke utsettes for vann eller fuktighet. GARANTI: IPAS yter 5 års garanti. Se også ASLEM12 for mer informasjon.

Resirkulering/WEEE:

Produktet er definert som miljøavfall og skal samles inn av et EE-returselskap. IPAS er medlem av Renas AS. Se mer på www.renas.no



IPAS AS

Østre Rosten 2A 7075 TILLER

www.ipas.no post@ipas.no Tlf 40 00 15 59

V.05.07.2019



Frisbee

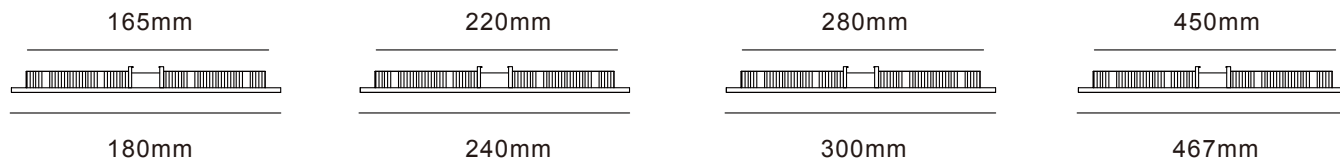

IMPORTANT INFORMATION:

1. Please read this instruction carefully before installation and keep it for future reference.
2. Please conform to the instruction of equipment and installed by professional.
3. Make sure correct voltage applied before use and keep away from heat and vibration source.
4. The light source of this luminaire is not replaceable. When the light source reaches its end of life the whole luminaire shall be replaced.
5. For indoor use only.

MAIN PARAMETER:

| Product | 231004 Mini | 231804 Midi | 232404 Maxi | 233604 Mega |
|-----------------------|---------------------------|---------------------------|---------------------------|---------------------------|
| Rated voltage | AC 220-240V 50/60Hz | AC 220-240V 50/60Hz | AC 220-240V 50/60Hz | AC 220-240V 50/60Hz |
| LED Rated power | 10W | 18W | 24W | 36W |
| System power | 12W | 20W | 25W | 40W |
| LED Type | LED SMD 2835 | LED SMD 2835 | LED SMD 2835 | LED SMD 2835 |
| LED Driver | Constant Current 250mA | Constant Current 420mA | Constant Current 560mA | Constant Current 950mA |
| Color Temperature | 3000K | 3000K | 3000K | 3000K |
| Protection | CLASS II | CLASS II | CLASS II | CLASS II |
| Beam Angle | 120 ° | 120 ° | 120 ° | 120 ° |
| IP Rated | IP20 | IP20 | IP20 | IP20 |
| Operation Temperature | -40°C~50°C | -40°C~50°C | -40°C~50°C | -40°C~50°C |
| Cut-out size | Ø165mm | Ø220mm | Ø280mm | Ø450mm |
| Product size | Ø180mmxH15mm | Ø240mmxH15mm | Ø300mmxH15mm | Ø467mmxH15mm |

INSTALLATION INSTRUCTIONS:

1. Always switch off the power supply before installation.
2. Make sure all parts are ready when open the box and prepare the installation tools the lighting needs.
3. Should be installed by qualified electricians.
4. If there is any damage on the housing or glass cover, should view it as disqualified product that cannot be used.
5. If the external flexible cable or cord of this luminaire is damaged, it shall be exclusively replaced by the manufacturer or his service agent or a similar qualified person in order to avoid a hazard.

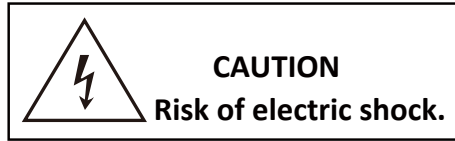
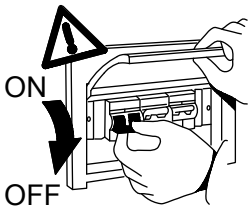

INSTALLATION STEPS:

1. Cut-out for the downlight.

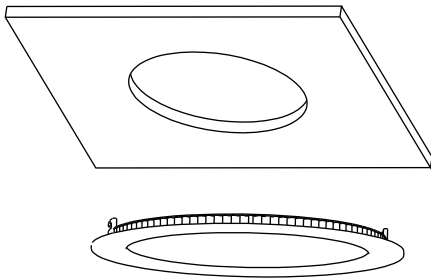

| Article nr | Cut-out(mm) |
|------------|-------------|
| 231004 | Ø165 |
| 231804 | Ø220 |
| 232404 | Ø280 |
| 233604 | Ø450 |

2. This luminaire is pre-wired with 1.5M cable and plug for connection to the Mains supply. Slide the mounting spring clips into the ceiling cut-out and push the luminaire up into cutting hole. Ensure that it is securely located. 220-230VAC

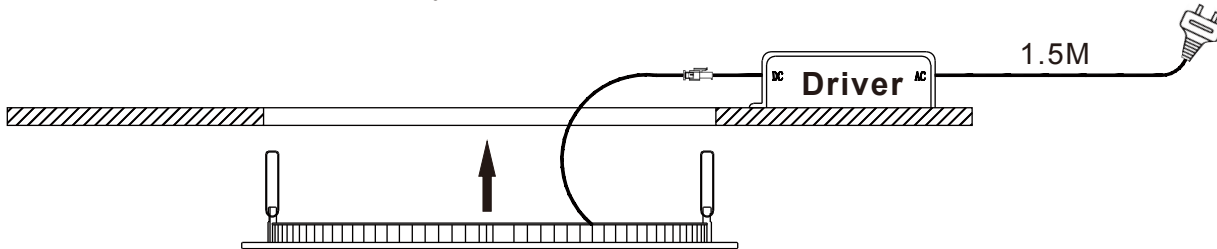

3. Switch on the power supply. 220-230VAC

