

Installation instruction

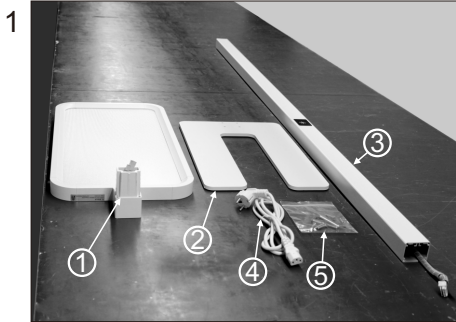

Product list: ① lamp ② base plate
③ pole ④ power cord
⑤ accessories bag

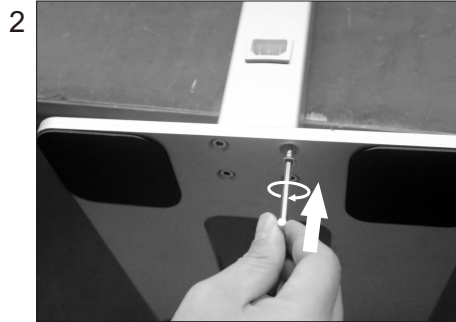

Fix the pole on the base plate

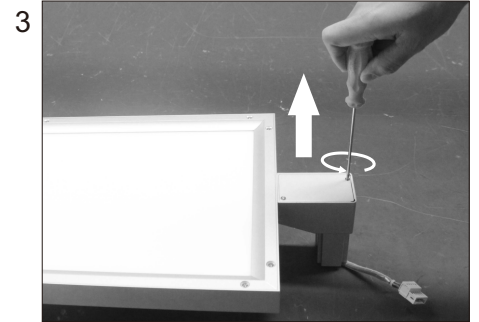

Open the enclosure

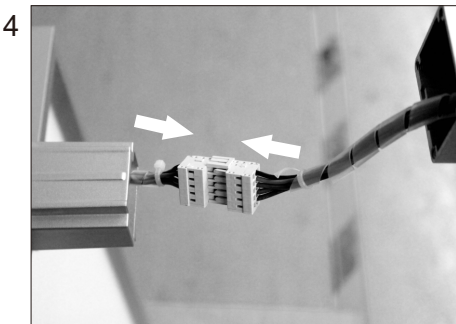

Connect the terminal

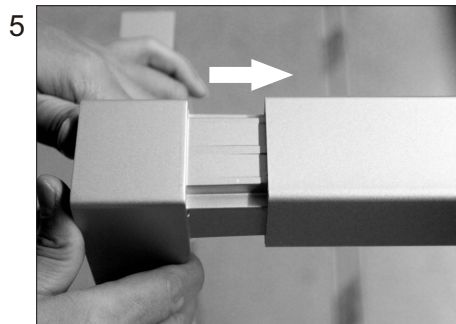

Insert the lamp holder into the other end of the pole

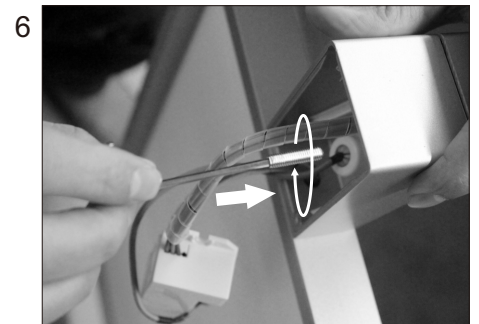

Fix the lamp holder with screws-1

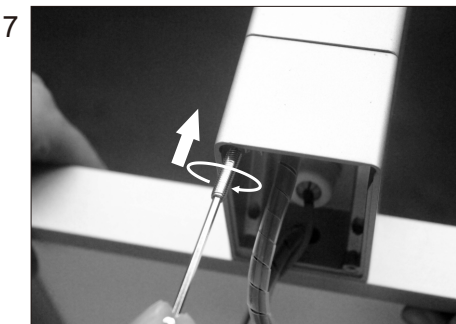

Fix the lamp holder with screws-2



Fix the lamp holder with screws-3

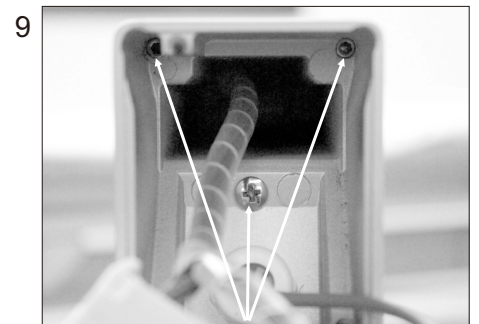

Fix the lamp holder with 3 screws
(e.g: Figure 5.6.7.)

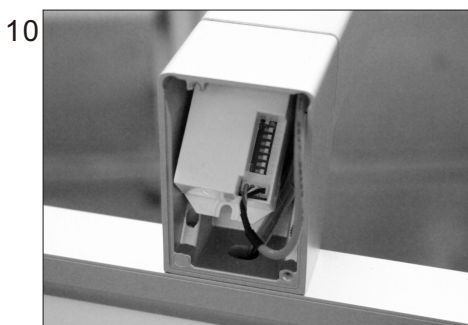

Fix the PIR sensor into the holder

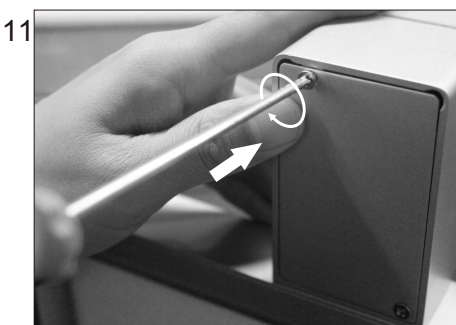

Cover the enclosure

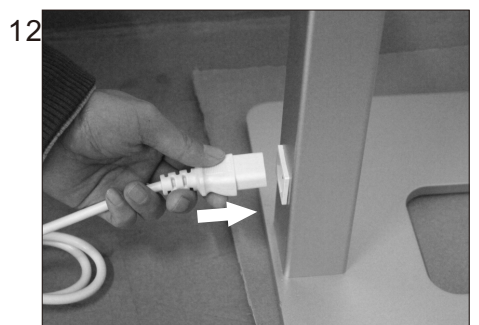

Insert the power cord

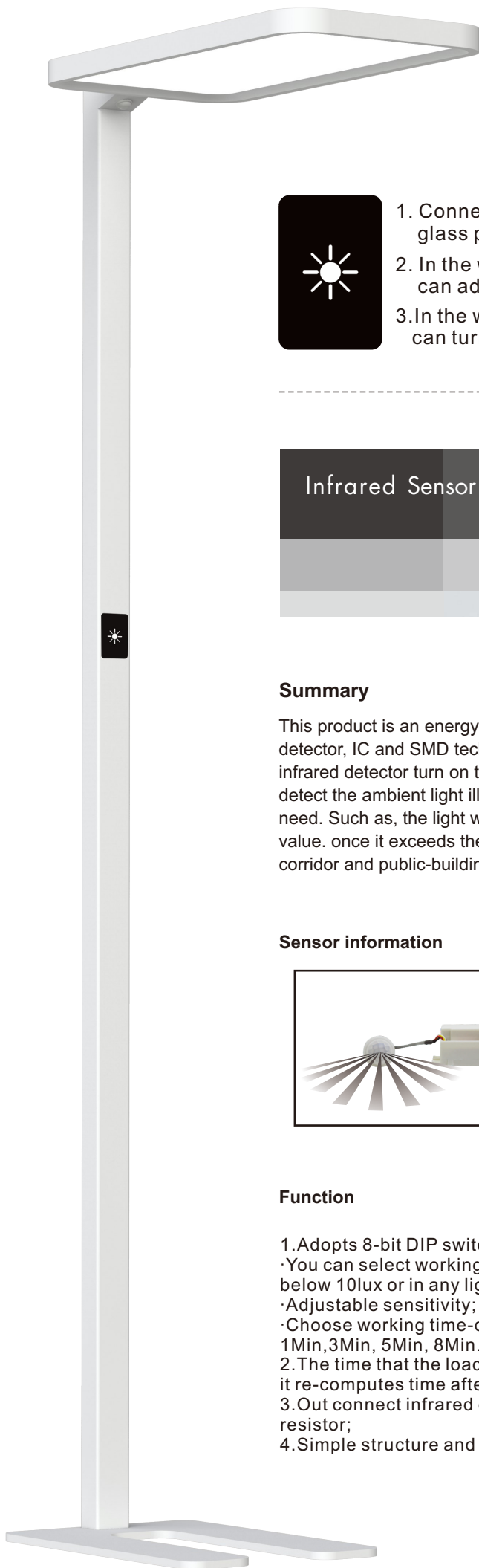

1. Connect with the power, and then short press the Pattern of the glass panel to turn on the light.
2. In the working status, to long press the Pattern of the glass panel can adjust light dimming effect.
3. In the working status, to short press the Pattern of the glass panel can turn off the light.

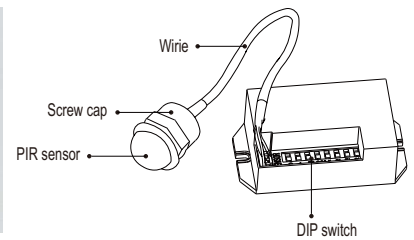
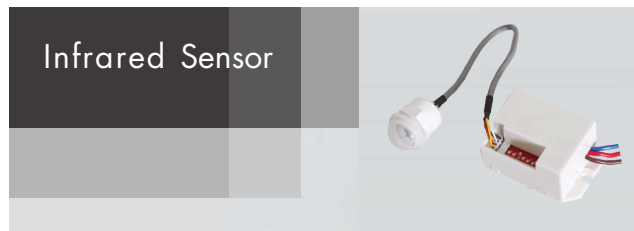

Summary

This product is an energy automatic sensor switch, it can identify day and night. It adopts infrared detector, IC and SMD technology, when someone enter its detecting range and triggered it work, the infrared detector turn on the lamp, after he leave its range, the lamp will turn off automatically. It can detect the ambient light illumination automatically and set and adjust the value according to the fact need. Such as, the light will turn on and works when the ambient light illumination is under setting value. once it exceeds the setting value, the light will stop working. It can be installed in indoor, corridor and public-building.

Sensor information

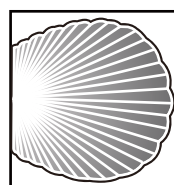
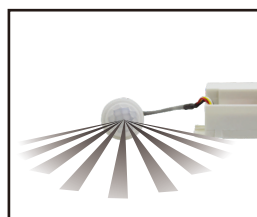

8m (22°C)
Correct moving orientation

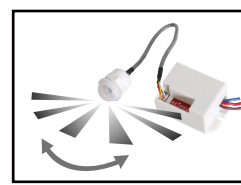

100°
Detection angle

Function

1. Adopts 8-bit DIP switch:
 - You can select working light to work only in the light below 10lux or in any light;
 - Adjustable sensitivity;
 - Choose working time-delay of the load: 5s, 30s, 1Min, 3Min, 5Min, 8Min.
2. The time that the load work can delay automatically: it re-computes time after the last sensing;
3. Out connect infrared detector and sensitization resistor;
4. Simple structure and using convenient.

