

# FDV DOKUMENT 3316015

ipas™

Maya R Gulv Opp-Ned PIR 60W 830 2650lm/2650lm  
33 160 15 / 106404

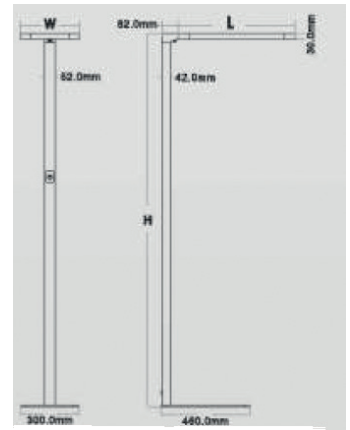

Art nr	El.nr.	Tekst	Farge	Lysfarge	Lumen	Dim. (L x B x H)
106404	33 160 15	Maya R Gulv Opp-ned PIR AV/PÅ 60W	Hvit	3000K	5100	300x300x1960mm



**GARANTI:** IPAS yter 5 års garanti. Se også ASLEM12 for mer informasjon.

Tekniske data:	54W 230V (System effekt 60W)
Spenning:	200-240V AC 50/60Hz
Tilkobling:	Schuko-plugg via kontakt ved sokkel
Driftsstrøm:	1050 mA
Dimming:	Nei - kun sensor og AV/PÅ.
Omgivelsestemp.:	-20 °C + 65 °C
Sikkerhet:	Kortslutningssikring med auto-reset, Termosikring med auto-reset
EMC standard:	EN55015, EN61547, EN61000-3-2/3
Sikkerhets standard:	EN613471, EN61347-2-13, EN60598-1
Sertifisert:	TÜV, CE, EMC
IP klasse LED Driver:	IP20
IP klasse LED Panel:	IP20
UGR:	<19
Armaturområde data:	Matt Hvit farge; materiale aluminium
Diffuser:	ja
Reflektor:	nei
LED:	Edison SMD 2835 LED (144 stk)
Utbyttbar LED?	Nei, det gir dårligere kjøling, mindre lys og kortere levetid
Isolasjonsklasse:	Klasse I
Driftsstrøm:	1050 mA konstantstrøm (CC)
Lysytelse:	2650 lumen opp / 2650 lumen ned (50%/50%)
CRI:	Ra>80
Strålingsvinkel:	120°
Levetid:	50 000 timer (L70/B50)
Produktstørrelse:	300 x 300 x 30 mm - armatur - Lengde på fot 1960 mm

Vekt: 4000 g

Antall stk per eske: 1 stk Dimensjon: 2200x300x40 mm Vekt: 4400 gram

HMS:

Produktet samsvarer med RoHS og inneholder ikke kvikksølv eller bly  
95% av produktene til IPAS sendes med saktegående sjøfrakt. Det vil si at skipene går med saktere fart for å spare drivstoff og avgir mindre CO2.

IPAS har vært medlem av Renas siden 2007 og alle produktene skal leveres tilbake til returpunkter for resirkulering. 98% av LED armaturer kan resirkuleres.

Energisparing: Generelt representerer bytte fra halogen til LED > 90% energisparing

Ved dimming er energibesparelse høyere. Ved sensor/lysstyring får du maks besparelse.

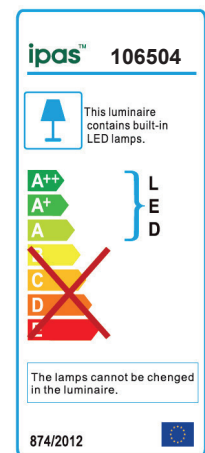

## Rengjøring:

Planmessig rengjøring gir deg best belysning over tid.

**Gjør anlegg alltid strømløst før rengjøring.**

Det anbefales støvtørking med mikrofiber. Intervaller avhenger av bruksområdets støv-/smusmengde. Unngå sterke kjemikalier (pH>7) og vær varsom med frontlinse eller reflektor hvis denne er tilgjengelig. Ikke spray midler direkte på armatur.

Særlig tilsmussede områder kan rengjøres med mildt såpevann, men prøv på et avgrenset område først.

LED Driver eller åpne komponenter må ikke utsettes for vann eller fuktighet.



# Installation instruction

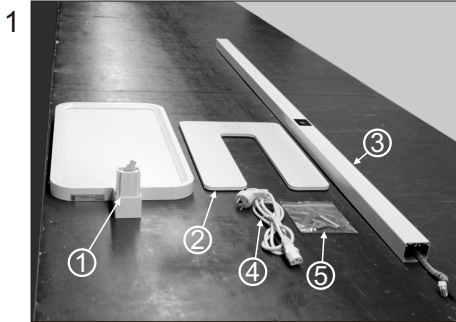

Product list: ① lamp ② base plate  
③ pole ④ power cord  
⑤ accessories bag

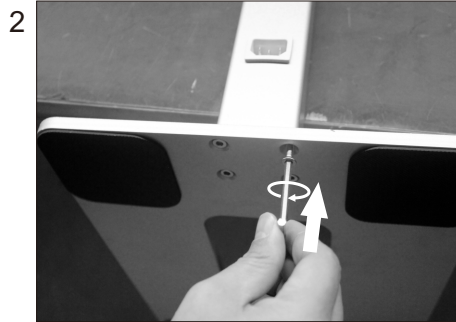

Fix the pole on the base plate

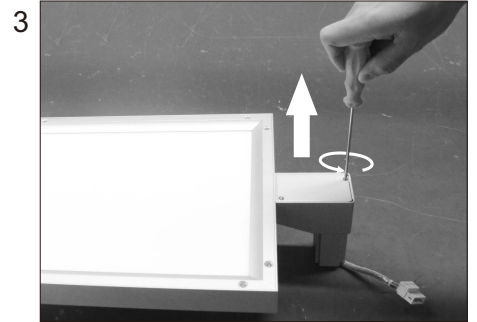

Open the enclosure

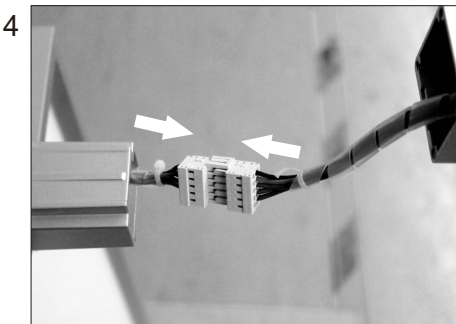

Connect the terminal

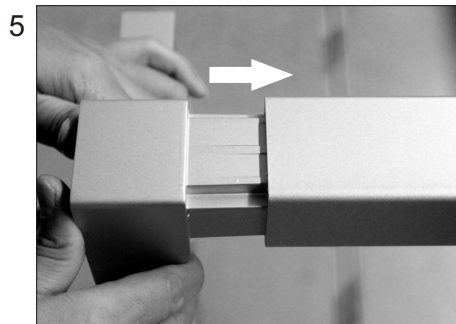

Insert the lamp holder into the other end of the pole

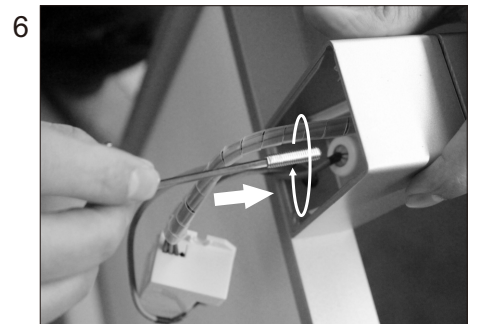

Fix the lamp holder with screws-1

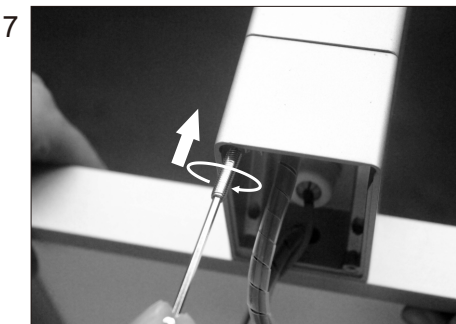

Fix the lamp holder with screws-2



Fix the lamp holder with screws-3

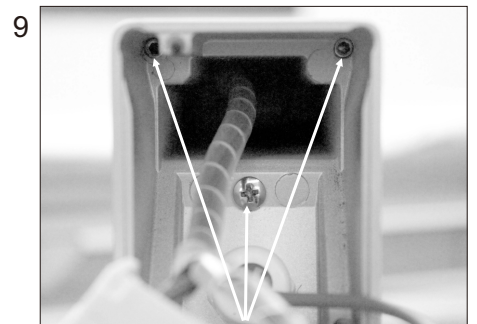

Fix the lamp holder with 3 screws  
(e.g: Figure 5.6.7.)

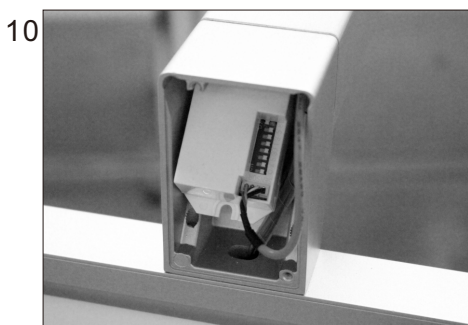

Fix the PIR sensor into the holder

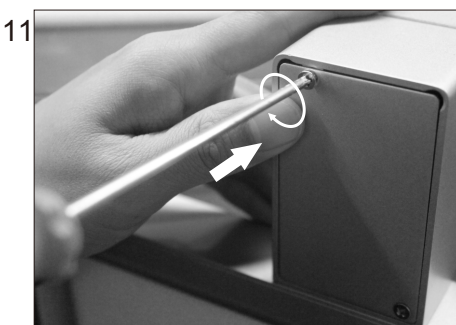

Cover the enclosure

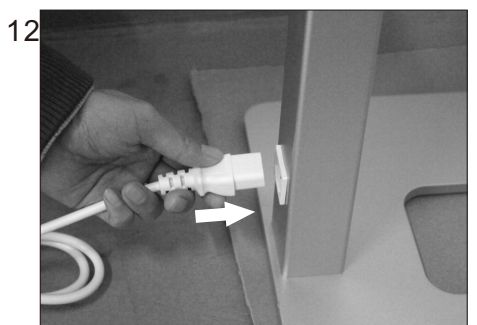

Insert the power cord

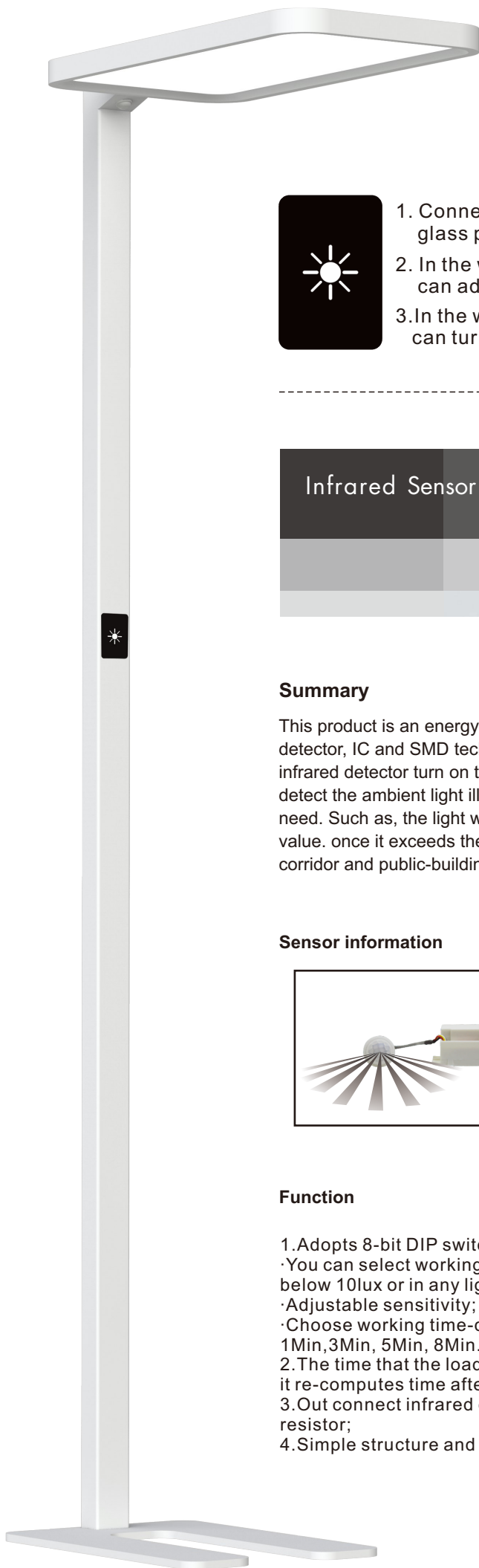

1. Connect with the power, and then short press the Pattern of the glass panel to turn on the light.
2. In the working status, to long press the Pattern of the glass panel can adjust light dimming effect.
3. In the working status, to short press the Pattern of the glass panel can turn off the light.

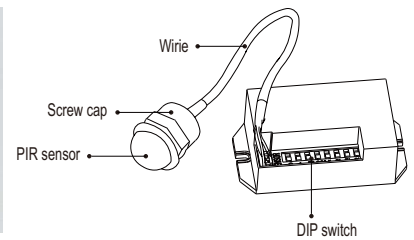
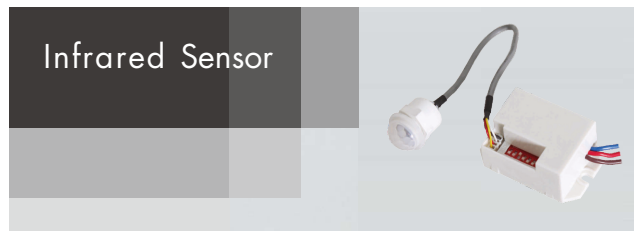

### Summary

This product is an energy automatic sensor switch, it can identify day and night. It adopts infrared detector, IC and SMD technology, when someone enter its detecting range and triggered it work, the infrared detector turn on the lamp, after he leave its range, the lamp will turn off automatically. It can detect the ambient light illumination automatically and set and adjust the value according to the fact need. Such as, the light will turn on and works when the ambient light illumination is under setting value. once it exceeds the setting value, the light will stop working. It can be installed in indoor, corridor and public-building.

### Sensor information

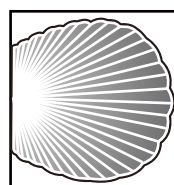
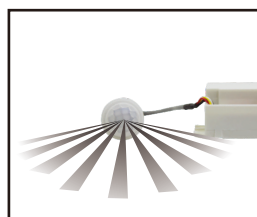

8m (22°C)  
Correct moving orientation

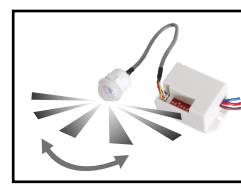

100°  
Detection angle

### Function

1. Adopts 8-bit DIP switch:
  - You can select working light to work only in the light below 10lux or in any light;
  - Adjustable sensitivity;
  - Choose working time-delay of the load: 5s, 30s, 1Min, 3Min, 5Min, 8Min.
2. The time that the load work can delay automatically: it re-computes time after the last sensing;
3. Out connect infrared detector and sensitization resistor;
4. Simple structure and using convenient.

