



DATA SHEET

residual current circuit-breaker

DFS 4 100-4/0,03-A KV R

sensitive to pulsating and alternating currents Type A, increased surge-current resistant, short-time delayed, lightning resistant

Article number 09164919



[Internetlink](#)



Function

Residual current circuit-breakers (RCCBs) are components for implementing protective measure "Automatic disconnection of the power supply" as per VDE 0100 part 410 or corresponding international installation regulations. Series DFS 4 devices are compact two or four-pole residual current circuit-breakers. In the standard design, they only take up four module width units of space. Although DFS 4 devices for AC and pulsating DC residual currents are actually designed for three-phase networks, they can also be used in single-phase networks. However, in addition to these, special variants are also available for single or three-phase operation in the form of the AC/DC sensitive designs (type B, type B+). In spite of the compact dimensions, a number of different tripping currents and characteristics are available at rated currents, depending on the design, up to 125 A. They also have large two-tier terminals for large conductor cross-sections, a practical multi-functional switch toggle and can be provided with labels using free-of-charge software. Type A residual current circuit-breakers are sensitive to pulsating and alternating currents. This function is independent of the mains voltage. Because they feature a response delay, residual current circuit-breakers in the KV design only respond to residual currents that last longer than a half-period of the power frequency. In contrast to instantaneous breakers, they are significantly less sensitive to brief impulse-like residual currents and facilitate problem-free operation, even when lightning or switching overvoltage in the system causes capacitive surge residual currents or insulation flashovers with a secondary current up to the zero point of the mains voltage. They therefore meet the requirements for lightning-resistant RCCBs as per Austrian standard ÖVE E 8601. The tripping times set out in national and international design regulations for instantaneous RCCBs are also observed by the KV design devices. In principle, therefore, they may be used instead of a standard breaker. Devices in the standard design are intended for monitoring circuits with a rated voltage of 230 V/400 V and a rated frequency of 50 Hz.

Features

high immunity against surge currents and mains-voltage-operated secondary current impulses, tripping not dependent on mains and auxiliary voltage, sensitive to AC residual currents and pulsating DC residual currents (type A), compact design for all rated currents, high short-circuit resistance, double-sided two-tier terminals for large conductor cross-section and busbar, switch position indicator, viewing window for labels, multifunction switch toggle with three positions: "on", "off" and "tripped", Neutral conductor position right

Mounting

quick fastening to mounting rail, any installation position, supply from any direction

Applications

Power supplies to residential and purpose-built building as well as industrial facilities with TN-S, TT and TN-C-S networks, in which conventional RCCBs trip following transient leakage currents and this is not desired, such as in systems with long cable lengths behind the RCCB, lighting systems with lots of fluorescent lamps (> 20 lamps), computer systems and solar power systems, Excluded is the application in TN-C systems and for the protection of installations in which electronic equipment could generate smooth DC currents or residual currents with frequencies other than 50 Hz. Comprehensive protection is not provided in this case. For these applications we recommend our AC/DC sensitive residual current circuit-breakers (Type B or B+).

Accessories

automatic reclosing devices DFA, terminal caps KA, information stickers HAS, auxiliary switches DHi, restart locks WES, software DBS

Technical Data

Technical Data	DFS 4 100-4/0,03-A KV R
Series	DFS 4 A KV
Number of poles	4
Residual current type	A
Rated current (AC)	100 A

Technical Data		DFS 4 100-4/0,03-A KV R
Rated residual current $I_{\Delta n}$		0.03 A
Short-time delayed		true
Selective		false
min. Operating voltage range of test circuit		150 V
max. Operating voltage range of test circuit		250 V
Non-trip time		10 ms
Maximum disconnection times		$1 \cdot I_{\Delta n} \leq 300 \text{ ms}; 5 \cdot I_{\Delta n} \leq 40 \text{ ms}$
		load circuit
Specification		load disconnect contact
min. Contact opening		4 mm
Rated voltage (AC)		230 V, 400 V
Rated current (AC)		100 A
Rated short-circuit current		10 kA
Surge current strength		3 kA
max. total rated switching capacity		1000 A
Rated insulation voltage		400 V
Rated impulse withstand voltage		4 kV
Rated frequency		50 Hz
Current heat loss per current path		7.5 W
thermal Backup-fuse OCPD		80 A
short-circuit backup-fuse SCPD		125 A
Back-up fuse type		gG
		screw-type terminal top and bottom (load circuit)
Neutral conductor position		right
Protection against direct contact		DGUV V3, VDE 0660-514, finger and back-of-hand proof
Connection C1 Maximum number of conductors per terminal		2 (conductors of same type and cross-section)
Cross section solid		1-wire: 1.5 mm ² ... 50 mm ² ; 2-wire: 1.5 mm ² ... 16 mm ²
Connecting capacity flexible		1-wire: 1.5 mm ² ... 50 mm ² ; 2-wire: 1.5 mm ² ... 16 mm ²
Cross section stranded		1-wire: 1.5 mm ² ... 50 mm ² ; 2-wire: 1.5 mm ² ... 16 mm ²
Tightening torque		2.5 Nm ... 3 Nm
		General data
Operating position		optional
max. Operating altitude above MSL		2000 m
Mechanical endurance		min. 5000 cycles
Electrical endurance		min. 2000 cycles
Surrounding atmosphere		normal environmental conditions
Storage temperature		-35 °C ... 75 °C
Ambient temperature		-25 °C ... 40 °C
Climate resistance		according to IEC 60068-2-30: humid heat / cyclic (25 °C / 55 °C; 93 % / 97 % RH)
Shock resistance		20 g / 20 ms Duration
Fatigue limit		> 5 g ($f \leq 80 \text{ Hz}$, duration > 30 min.)
Housing type		distribution board housing
Installation type		Mounting rail (35 mm)
Housing material		thermoplastic

Technical Data	DFS 4 100-4/0,03-A KV R
Protection class	IP20 (installed: IP40)
sealable	true
Width	72 mm
Height	85 mm
Depth	75 mm
Installation depth	69 mm
Module widths	4
Design requirements/Standards	VDE 0664-10, EN 61008-1, ÖVE/ÖNORM E 8601
Certifications	VDE
Degree of pollution according to EN 60664	2

Dimensions

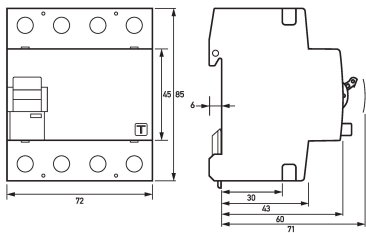

Dimensional drawing Group view

STEP file

Wiring example

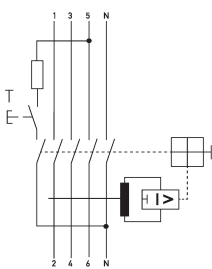

Wiring diagram