



TIME RELAY, MULTI-FUNCTION, 2 CO CONT., 27 FUNCT., 15 TIME SET. RANGES (1, 3, 10, 30, 100) (S/MIN/HR), 400-440V AC AT AC 50/60HZ, LED, SPRING-LOADED TERMINAL (PUSH-IN)

Figure similar

General technical data:		
product brand name		SIRIUS
Product designation		timing relay
Mounting position		any
Product function at the relay outputs Switchover delayed/without delay		Yes
Product function non-volatile		No
Product component		
• Relay output		Yes
• semi-conductor output		No
Installation altitude at height above sea level maximum	m	2 000
Ambient temperature		
• during operation	°C	-25 ... +60
• during storage	°C	-40 ... +85
• during transport	°C	-40 ... +85
Relative humidity during operation	%	10 ... 95
EMC emitted interference acc. to IEC 61812-1		EN 61000-6-4(3)
EMI immunity acc. to IEC 61812-1		EN 61000-6-2

Conducted interference due to burst acc. to IEC 61000-4-4		2 kV network connection / 1 kV control connection
Conducted interference due to conductor-earth surge acc. to IEC 61000-4-5		2 kV
Conducted interference due to conductor-conductor surge acc. to IEC 61000-4-5		1 kV
Electrostatic discharge acc. to IEC 61000-4-2		4 kV contact discharge / 8 kV air discharge
Field-bound parasitic coupling acc. to IEC 61000-4-3		10 V/m
Surge voltage resistance rated value	V	4 000
Power loss [W] total typical	W	2
Equipment marking acc. to DIN 40719 extended according to IEC 204-2 acc. to IEC 750		K
Equipment marking acc. to DIN EN 81346-2		K
Category acc. to EN 954-1		none
Protection against electrical shock		finger-safe
Protection class IP		IP20
Mechanical service life (switching cycles) typical		10 000 000
Electrical endurance (switching cycles) at AC-15 at 230 V typical		100 000
Operating frequency with 3RT2 contactor maximum	1/h	5 000
Vibration resistance acc. to IEC 60068-2-6		10 ... 55 Hz / 0.35 mm
Shock resistance acc. to IEC 60068-2-27		11g / 15 ms
Relative repeat accuracy	%	1
Recovery time	ms	150
Minimum ON period	ms	35
Degree of pollution		3
Insulation voltage for overvoltage category III according to IEC 60664 with degree of pollution 3 rated value	V	500
Relative setting accuracy relating to full-scale value	%	5

#### Switching Function:

##### Switching function

- ON-delay
- ON-delay/instantaneous contact
- passing make contact
- passing make contact/instantaneous contact
- OFF delay
- flashing asymmetrically starting with interval
- flashing asymmetrically starting with pulse
- flashing symmetrically starting with pulse
- flashing symmetrically starting with pulse/instantaneous
- flashing symmetrically starting with interval

Yes  
Yes  
Yes  
Yes  
Yes  
No  
No  
Yes  
Yes  
Yes

<ul style="list-style-type: none"> <li>flashing symmetrically starting with interval/instantaneous</li> <li>star-delta circuit</li> <li>star-delta circuit with delay time</li> </ul>		Yes
		Yes
		No
<b>Switching function with control signal</b>		
<ul style="list-style-type: none"> <li>additive ON delay</li> <li>passing break contact</li> <li>OFF delay</li> <li>pulse-shaping</li> <li>OFF delay/instantaneous</li> <li>ON-delay/OFF-delay/instantaneous</li> <li>passing break contact/instantaneous</li> <li>additive ON delay/instantaneous</li> <li>ON-delay/OFF-delay</li> <li>passing make contact</li> <li>passing make contact/instantaneous contact</li> <li>pulse delayed</li> <li>pulse delayed/instantaneous</li> <li>pulse-shaping/instantaneous</li> </ul>		Yes
		Yes
		Yes
		Yes
		Yes
		Yes
		Yes
		Yes
		Yes
		Yes
		Yes
		Yes
		Yes
<b>Switching function of interval relay with control signal</b>		
<ul style="list-style-type: none"> <li>retrotriggerable with deactivated control signal/instantaneous contact</li> <li>retrotriggerable with activated control signal</li> <li>retrotriggerable with activated control signal/instantaneous contact</li> <li>retriggerable with deactivated control signal</li> </ul>		Yes
		Yes
		Yes
		Yes
<b>Design of the control terminal non-floating</b>		Yes

#### Control circuit/ Control:

<b>Adjustable time</b>	s	0.05 ... 360 000
<b>Type of voltage of the control supply voltage</b>		AC
<b>Control supply voltage frequency 1</b>	Hz	50 ... 60
<b>Control supply voltage 1</b>		
<ul style="list-style-type: none"> <li>at AC</li> <li>— at 50 Hz</li> <li>— at 60 Hz</li> </ul>	V	400 ... 440
	V	400 ... 440
<b>Operating range factor control supply voltage rated value</b>		
<ul style="list-style-type: none"> <li>at AC</li> <li>— at 50 Hz</li> <li>— at 60 Hz</li> </ul>		0.85 ... 1.1
		0.85 ... 1.1

#### Auxiliary circuit:

<b>Contact reliability of auxiliary contacts</b>		one incorrect switching operation of 100 million switching operations (17 V, 5 mA)
<b>Material of switching contacts</b>		AgSnO <sub>2</sub>
<b>Operating current of auxiliary contacts</b>		
• at AC-15		
— at 24 V	A	3
— at 250 V	A	3
• at DC-13		
— at 24 V	A	1
— at 125 V	A	0.2
— at 250 V	A	0.1
<b>Design of the fuse link for short-circuit protection of the auxiliary switch required</b>		fuse gL/gG: 4 A
<b>Thermal current</b>	A	5
Switching capacity current with inductive load	A	0.01 ... 3
<b>Number of NC contacts</b>		
• delayed switching		0
• instantaneous contact		0
<b>Number of NO contacts</b>		
• delayed switching		0
• instantaneous contact		0
<b>Number of CO contacts</b>		
• delayed switching		2
• instantaneous contact		0

#### Installation/ mounting/ dimensions:

<b>Mounting type</b>		screw and snap-on mounting onto 35 mm standard mounting rail
<b>Width</b>	mm	22.5
<b>Height</b>	mm	100
<b>Depth</b>	mm	90
<b>Required spacing with side-by-side mounting</b>		
• upwards	mm	0
• forwards	mm	0
• at the side	mm	0
• Backwards	mm	0
• downwards	mm	0
<b>Required spacing for grounded parts</b>		
• Backwards	mm	0
• at the side	mm	0
• upwards	mm	0
• forwards	mm	0
• downwards	mm	0

<b>Required spacing for live parts</b>		
• downwards	mm	0
• Backwards	mm	0
• at the side	mm	0
• forwards	mm	0
• upwards	mm	0

#### Connections/ Terminals:

<b>Type of electrical connection for auxiliary and control current circuit</b>		PUSH-IN connection (spring-loaded connection)
<b>Type of connectable conductor cross-sections</b>		
• solid		0.5 ... 4 mm <sup>2</sup>
• finely stranded		
— without core end processing		0.5 ... 4 mm <sup>2</sup>
— with core end processing		0.5 ... 2.5 mm <sup>2</sup>
• at AWG conductors		
— solid		20 ... 12

#### Certificates/ approvals:

General Product Approval	other
 CCC	 CSA
 UL	<a href="#">Umweltbestätigung</a>

#### Further information

##### Information- and Downloadcenter (Catalogs, Brochures,...)

<http://www.siemens.com/industrial-controls/catalogs>

##### Industry Mall (Online ordering system)

<http://www.siemens.com/industrymall>

##### Cax online generator

<http://support.automation.siemens.com/WW/CAXorder/default.aspx?lang=en&mlfb=3RP25052BT20>

##### Service&Support (Manuals, Certificates, Characteristics, FAQs,...)

<https://support.industry.siemens.com/cs/ww/en/ps/3RP25052BT20>

##### Image database (product images, 2D dimension drawings, 3D models, device circuit diagrams, EPLAN macros, ...)

[http://www.automation.siemens.com/bilddb/cax\\_de.aspx?mlfb=3RP25052BT20&lang=en](http://www.automation.siemens.com/bilddb/cax_de.aspx?mlfb=3RP25052BT20&lang=en)

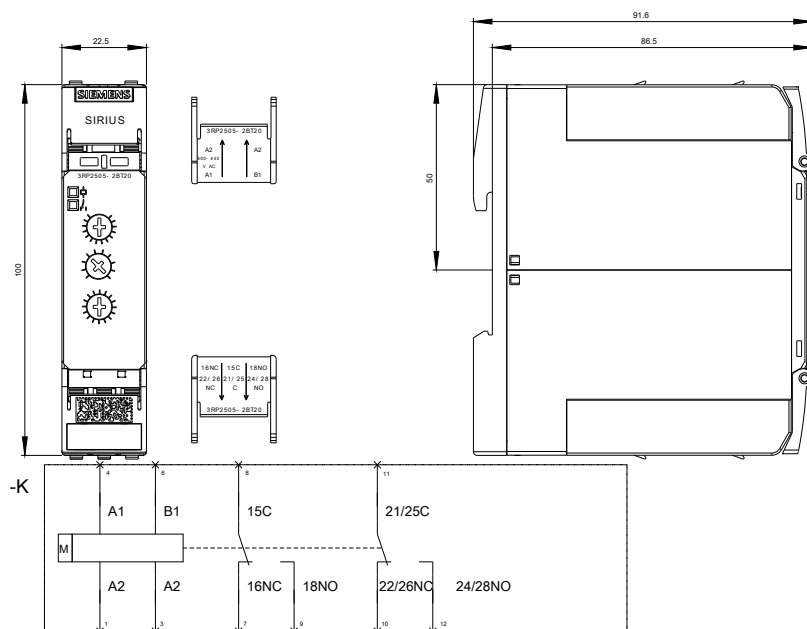

last modified:

08.02.2016