

LABELING PLATE SNAP-ON OR SELF-ADHESIVE FOR LABEL HOLDER, LABEL SIZE 12.5 X 27MM, LABEL BLACK, LETTERING WHITE, WITH INSCRIPTION: RUNNING



Figure similar

<b>Product brand name</b>	SIRIUS ACT
<b>Product designation</b>	Labeling plate
<b>Product type designation</b>	3SU1
<b>General technical data</b>	
<b>Protection class IP</b>	IP66, IP67, IP69(IP69K)
<b>Shock resistance</b>	Category 1, Class B
<ul style="list-style-type: none"> <li>• for railway applications acc. to DIN EN 61373</li> </ul>	
<b>Vibration resistance</b>	Category 1, Class B
<ul style="list-style-type: none"> <li>• for railway applications acc. to DIN EN 61373</li> </ul>	
<b>Installation/ mounting/ dimensions</b>	
<b>Height</b>	12.5 mm
<b>Width</b>	27 mm
<b>Accessories</b>	
<b>Material of accessory</b>	Plastic
<b>Mounting type of label</b>	snap on / stick
<b>Marking of the name plate for command devices</b>	Running
<b>Shape of the name plate for command devices</b>	rectangular

Color of the label

black/white (plate/text)

## Certificates/approvals

### General Product Approval



CSA



UL



EG-Konf.

### Declaration of Conformity

### Test Certificates

[Declaration of the  
Compliance with the  
order](#)

[Special Test  
Certificate](#)

## other

[Confirmation](#)

## Further information

### Information- and Downloadcenter (Catalogs, Brochures,...)

<http://www.siemens.com/industrial-controls/catalogs>

### Industry Mall (Online ordering system)

<https://mall.industry.siemens.com/mall/en/en/Catalog/product?mlfb=3SU1900-0AC16-0EB0>

### Cax online generator

<http://support.automation.siemens.com/WW/CAXorder/default.aspx?lang=en&mlfb=3SU1900-0AC16-0EB0>

### Service&Support (Manuals, Certificates, Characteristics, FAQs,...)

<https://support.industry.siemens.com/cs/ww/en/ps/3SU1900-0AC16-0EB0>

### Image database (product images, 2D dimension drawings, 3D models, device circuit diagrams, EPLAN macros, ...)

[http://www.automation.siemens.com/bilddb/cax\\_de.aspx?mlfb=3SU1900-0AC16-0EB0&lang=en](http://www.automation.siemens.com/bilddb/cax_de.aspx?mlfb=3SU1900-0AC16-0EB0&lang=en)

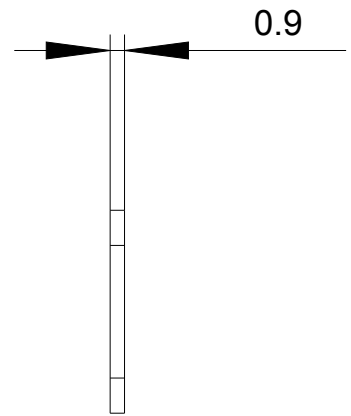
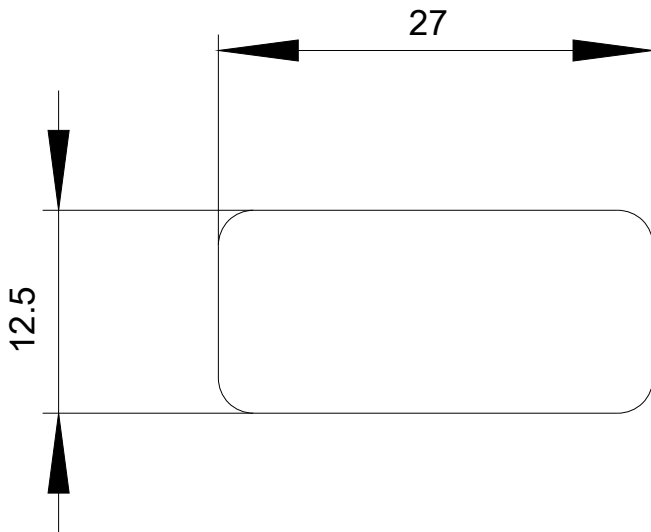

last modified:

07/10/2017