

LABELING PLATE SNAP-ON OR SELF-ADHESIVE FOR LABEL HOLDER, LABEL SIZE 12.5 X 27MM, LABEL BLACK, LETTERING WHITE, WITH GRAPHIC SYMBOL: I



Figure similar

Product brand name	SIRIUS ACT
Product designation	Labeling plate
Product type designation	3SU1





General technical data	
Protection class IP	IP66, IP67, IP69(IP69K)
Shock resistance	Category 1, Class B
<ul style="list-style-type: none"> for railway applications acc. to DIN EN 61373 	
Vibration resistance	Category 1, Class B
<ul style="list-style-type: none"> for railway applications acc. to DIN EN 61373 	

Installation/ mounting/ dimensions	
Height	12.5 mm
Width	27 mm

Accessories	
Material of accessory	Plastic
Mounting type of label	snap on / stick
Marking of the name plate for command devices	I
Shape of the name plate for command devices	rectangular

Color of the label	black/white (plate/text)
Printed ISO symbols	

Certificates/approvals

General Product Approval		Declaration of Conformity	Test Certificates		
 CSA	 UL		 EG-Konf.	Declaration of the Compliance with the order	Special Test Certificate

other

[Confirmation](#)

Further information

Information- and Downloadcenter (Catalogs, Brochures,...)

<http://www.siemens.com/industrial-controls/catalogs>

Industry Mall (Online ordering system)

<https://mall.industry.siemens.com/mall/en/en/Catalog/product?mlfb=3SU1900-0AC16-0QB0>

Cax online generator

<http://support.automation.siemens.com/WW/CAXorder/default.aspx?lang=en&mlfb=3SU1900-0AC16-0QB0>

Service&Support (Manuals, Certificates, Characteristics, FAQs,...)

<https://support.industry.siemens.com/cs/ww/en/ps/3SU1900-0AC16-0QB0>

Image database (product images, 2D dimension drawings, 3D models, device circuit diagrams, EPLAN macros, ...)

http://www.automation.siemens.com/bilddb/cax_de.aspx?mlfb=3SU1900-0AC16-0QB0&lang=en

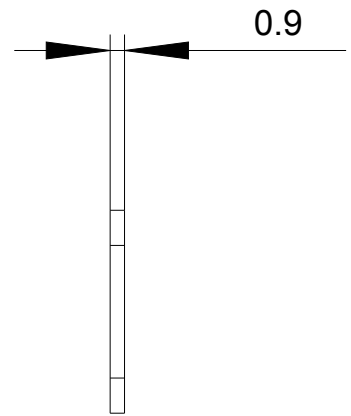
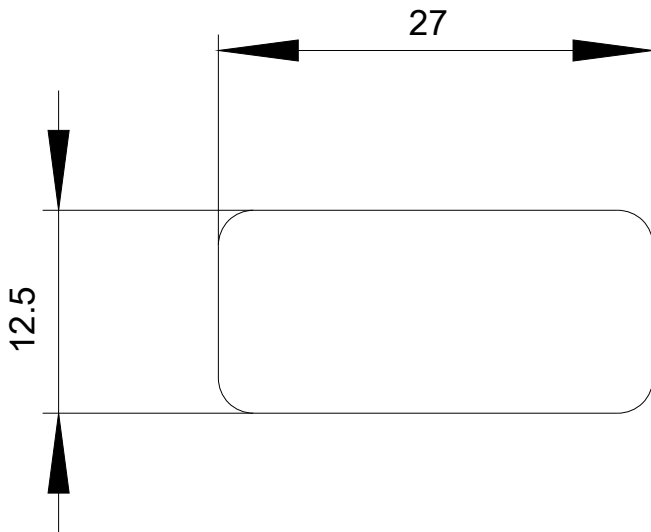

last modified:

07/10/2017