

Round conductor, stainless steel



- According to DIN EN 62561-2 (VDE 0185-561-2)
- Corresponds to the requirements of VDE 0185-305 (IEC 62305)
- RD 10-V4A for applications in the earth
- According to the foundation earther standard DIN 18014, V4A is required in the earth

Type	Nominal size Ø mm	Cross-section mm ²	Normal ring ca. m	Normal ring ca. kg	Weight kg/100 m	Item No.
RD 8-V2A	8	50	125	50	40,000	5021235
RD 10-V2A	10	78	50	32	63,000	5021227
RD 10-V2A	10	78	80	50	63,000	5021239
RD 8-V4A	8	50	125	50	40,000	5021644
RD 10-V4A 20	10	78	20	12	63,000	5021640
RD 10-V4A	10	78	50	32	63,000	5021642
RD 10-V4A	10	78	80	50	63,000	5021647

Dimensions

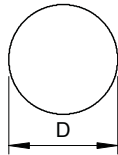

V2A Stainless steel, grade 304 **V4A** Stainless steel, 316Ti / 316L