

## Description



- Presence detector (PIR)
- Square detection area
- Ceiling mounted
- The square detection area allows accurate and simple planning
- Mixed light measurement
- Light switch output (relay, 230 V)
- Automatic lighting control
- Lighting control with light threshold value and self-learning switch-off delay
- Pulse function for staircase time switch
- Can be configured remotely
  - The switching behaviour of the presence detector is controlled by presence and light
  - The self-learning switch-off delay adjusts to occupants' behaviour
- The pulse function is for controlling a staircase time switch
- The presence detector has a mixed light measurement and is suitable for switching the following types of lamp: Fluorescent lamps (FL/PL), halogen and incandescent lamps as well as LEDs
- Test operation mode checks the detection area and installation
- The parameters can either be set using the potentiometer or via the optional service remote control QuickSet plus

## Technical data

Operating voltage	230 V AC
Frequency	50 Hz
Recommended installation height	2 – 3 m
Installation type	Ceiling installation
Power consumption	0,7 W
Light measurement	Mixed light measurement
Setting range brightness	10 – 1500 lx
Light switch-off delay	Impuls (0,5 s), 10 s-20 min
Type of contact light	Relay 230 V
Lamps	Incandescent/halogen lamps, fluorescent lamps, energy saving lamps, LEDs
Resistive load	1400 W
Incandescent/halogen lamp load	1200 W
Compact and fluorescent lamps	960 VA (cos f = 0,8), 580 VA (cos f = 0,5)
Compact and fluorescent lamps (Number of electronic ballasts)	10 x (1 x 58 W), 5 x (2 x 58 W), 16 x (1 x 36 W), 8 x (2 x 36 W), 16 x (smaller than 36 W)
Type of connection	Screw terminals
Max. cable cross section	2 x 2,5 mm <sup>2</sup>
Mounting plate	70 x 70 mm
Size of concealed housing	Ø 55 mm (NIS, PMI)
Ambient temperature	-20 °C ... +50 °C
Type of protection	IP 54

**Connection example**

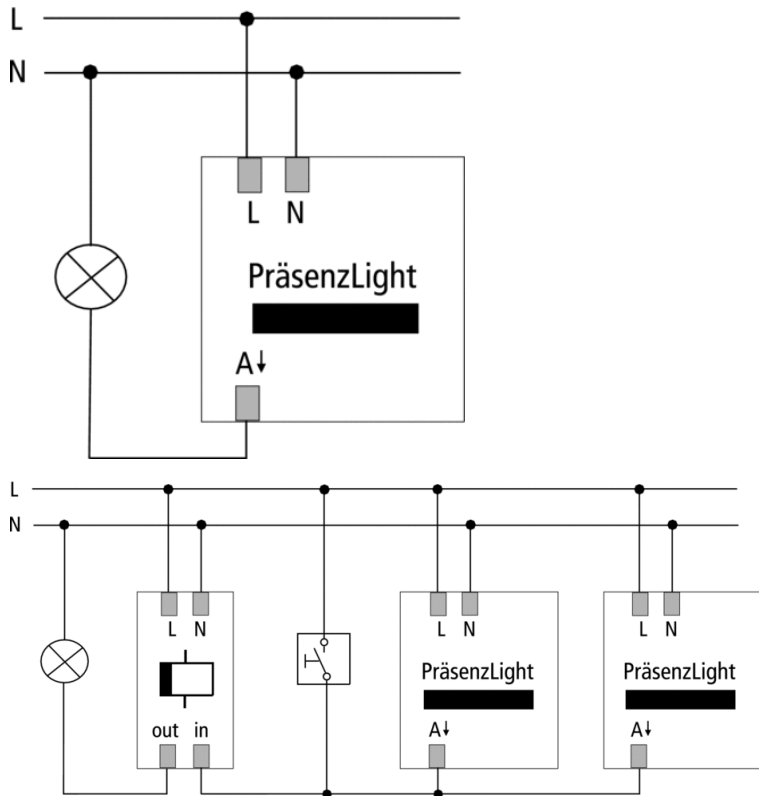

**Detection range**

Mounting height (A)	Sitting (B)	Walking (C)
2 m	9 m <sup>2</sup>   3 m x 3 m	20 m <sup>2</sup>   4,5 m x 4,5 m ± 0,5 m
2,5 m	16 m <sup>2</sup>   4 m x 4 m	36 m <sup>2</sup>   6 m x 6 m ± 0,5 m
3 m	20 m <sup>2</sup>   4,5 m x 4,5 m	49 m <sup>2</sup>   7 m x 7 m ± 1 m
3,5 m	–	64 m <sup>2</sup>   8 m x 8 m ± 1 m

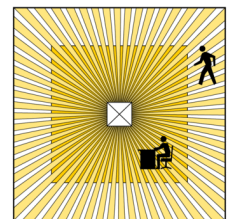
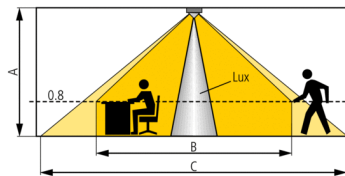

**Scale drawings**

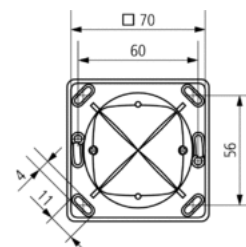
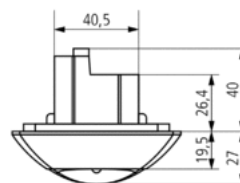
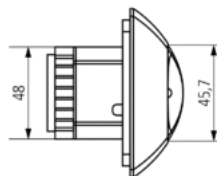
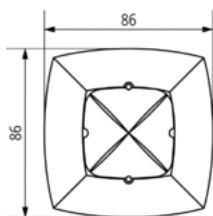

Article number: 2000000

## Accessories

### Surface frame PresenceLight

- Article number: 9070513  
[Details ▶ www.theben.de](http://www.theben.de)



### QuickSafe

- Article number: 9070531  
[Details ▶ www.theben.de](http://www.theben.de)



### QuickSet plus

- Article number: 9070532  
[Details ▶ www.theben.de](http://www.theben.de)



### clic

- Article number: 9070515  
[Details ▶ www.theben.de](http://www.theben.de)



## Product selection

Installation type	Channel	Operating voltage	Colour	Type	Article number	E-No
Ceiling installation	Light	230 V AC	Pure white (similar to RAL 9010)	PresenceLight 360	2000000	535950400
Ceiling installation	Light	230 V AC	Black (similar to RAL 9005)	PresenceLight 360 BK	2000800	535950409
Ceiling installation	Light	230 V AC	Silver (similar to RAL 9006)	PresenceLight 360 SR	2000801	535950407
Ceiling installation	Light	230 V AC	Pure white (similar to RAL 9010)	PräsenzLight 360-100A WH	2000001	535930304
Ceiling installation	Light	230 V AC	Black (similar to RAL 9005)	PräsenzLight 360-100A BK	2000806	535930324
Ceiling installation	Light	230 V AC	Silver (similar to RAL 9006)	PräsenzLight 360-100A SR	2000807	535930374