

compact passimo SR

Article number: 2010810

Description



- Presence detector (PIR)
- Mixed light measurement
- Automatic control of lighting and HVAC as well as room monitoring function
- Rectangular detection area for storage areas with clear demarcation vertically below the presence detector
- Light switch output (relay, 230 V)
- Presence switch output (relay, floating)
- Choice of fully or semi automatic operation
- Sensor or switch options for manual switching
- Fully or semi-automatic: In "Fully automatic" mode, the lighting switches on and off automatically according to presence and light. In "Semi-automatic" mode, it must be switched on manually and it switches off automatically
- Manual override: The lighting can be manually switched on or off at any time via sensors or switches
- Room/corridor sensor function: In the "corridor" setting, the detector functions as a staircase timer and it cannot be switched off manually
- Master/slave parallel switching: Up to ten detectors can be connected with each other to extend the detection area. The master switches the load. All other detectors merely provide presence information as slaves
- Device can be connected as master or slave
- Lighting control with light threshold value and self-learning switch-off delay
- Pulse function for staircase time switch
- HVAC control with switch-on and switch-off delay
 - Room monitoring with selective movement detection
 - The switching behaviour of the presence detector is controlled by presence and light
 - The self-learning switch-off adjusts to occupants' behaviour
 - The pulse function is for controlling a staircase time switch
- The presence detector has a mixed light measurement and is suitable for switching the following types of lamp: Fluorescent lamps (FL/PL), halogen and incandescent lamps as well as LEDs
- Presence switch contact for HVAC control: The switching behaviour of the floating contact is only controlled by presence
- The switch-on delay prevents instantaneous switch on. The contact only closes on completion of the switch-on delay
 - Master/master parallel switching: Up to ten detectors can be connected with each other to control several lighting groups. Each master controls its lighting group according to its own brightness measurements. Presence is detected by all the detectors
- The sensitivity of the presence switch output is reduced in the "monitoring" position. The contact indicates the presence of people with a high degree of certainty
- Test operation mode checks the detection area and installation
- The parameters can either be set using the potentiometer or via the optional service remote control QuickSet plus
- A maximum of 10 detectors can be switched at the same time

Technical data

| | |
|---------------------------------|-----------------------------|
| Operating voltage | 230 V AC |
| Frequency | 50 Hz |
| Light measurement | Mixed light measurement |
| Power consumption | 0,7 W |
| Setting range brightness | 10 – 1500 lx |
| Installation type | Ceiling installation |
| Recommended installation height | 2 – 3,5 m |
| Mounting plate | 70 x 70 mm |
| Max. cable cross section | 2 x 2,5 mm ² |
| Type of connection | Screw terminals |
| Size of concealed housing | Ø 55 mm (NIS, PMI) |
| Light switch-off delay | Impuls (0,5 s), 10 s-20 min |
| Presence switch-off delay | 10 s-120 min |

| | |
|--|--|
| Switch-on delay presence | 0 s – 10 min |
| Type of contact light | Relay 230 V |
| Switching capacity light | 960 VA (cos f = 0,8), 580 VA (cos f = 0,5) |
| Resistive load | 1400 VA |
| Incandescent/halogen lamp load | 1200 W |
| Compact and fluorescent lamps | 960 VA (cos f = 0,8), 580 VA (cos f = 0,5) |
| Compact and fluorescent lamps (Number of EVGs) | 10 x (1 x 58 W), 5 x (2 x 58 W), 16 x (1 x 36 W), 8 x (2 x 36 W), 16 x (smaller than 36 W) |
| Lamps | Incandescent/halogen lamps, Fluorescent lamps, Energy saving lamps, LEDs |
| Type of contact presence | Potential free relay |
| Switching capacity presence | 50 W (220 V DC), 50 VA (250 V AC) minimal 0,5 mV/10 mA |
| Switching output | Potential free |
| Ambient temperature | +0 °C ... +50 °C |
| Type of protection | IP 40 |

Detection range

| Mounting height (A) | Head on to (r) | Diagonally (t) |
|---------------------|-------------------|-------------------|
| 2 m | 8 m x 3,5 m ±1 m | 15 m x 3,5 m ±1 m |
| 2,5 m | 9 m x 4 m ±1 m | 15 m x 4 m ±1 m |
| 3 m | 10 m x 4,5 m ±1 m | 15 m x 4,5 m ±1 m |
| 3,5 m | 10 m x 5 m ±1 m | 15 m x 5 m ±1 m |

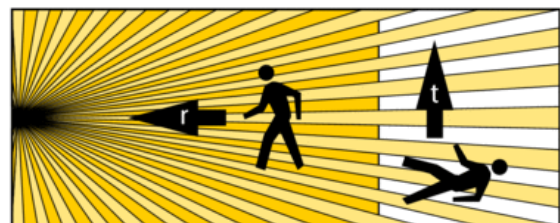
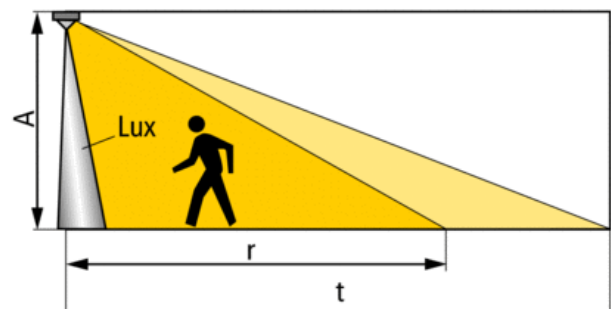

Scale drawings

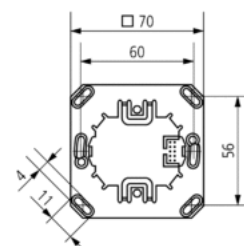
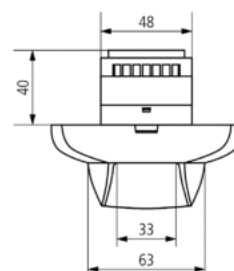
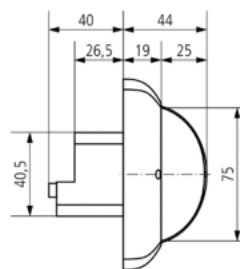
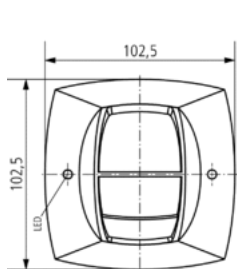

Connection example

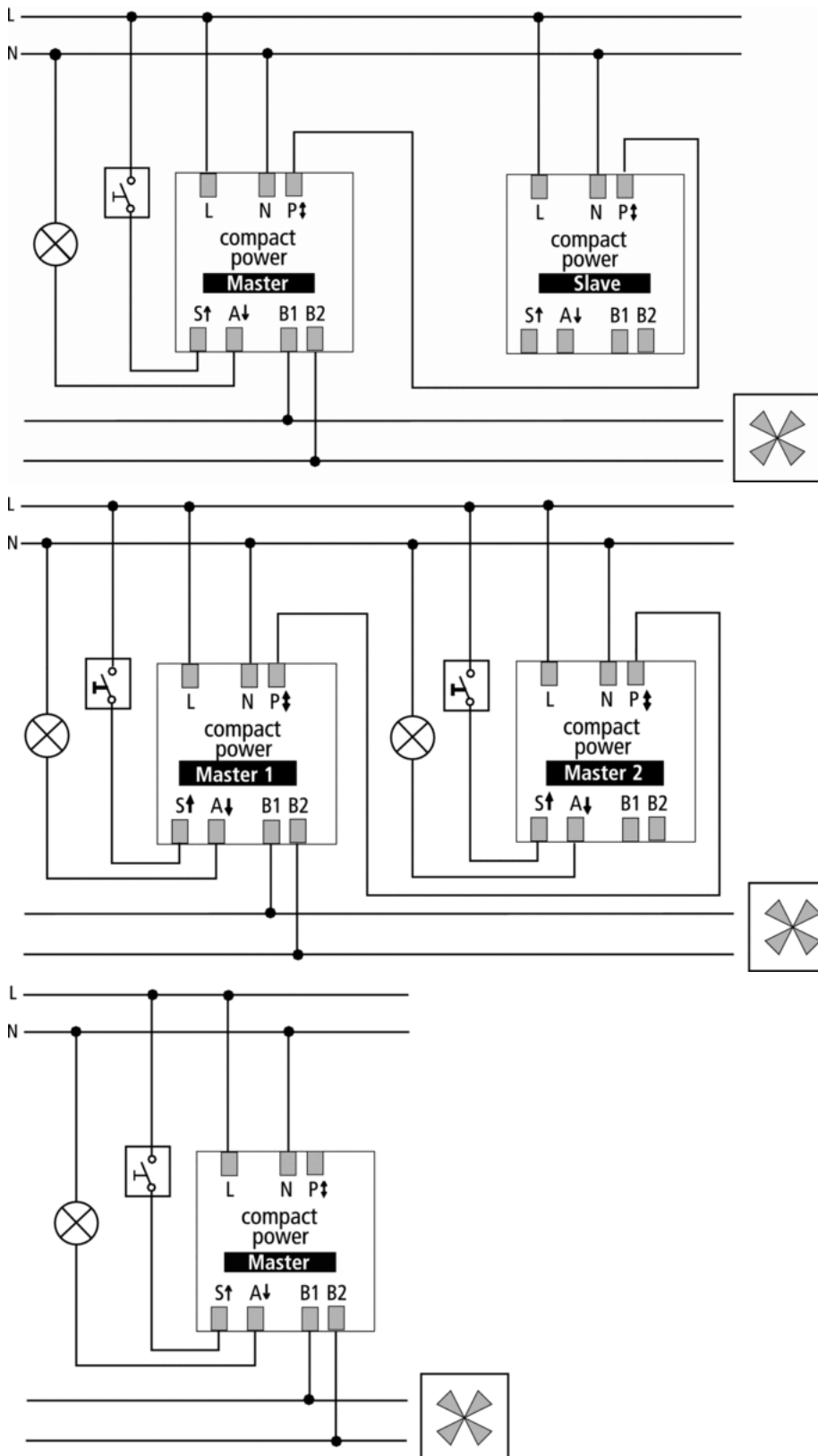

Accessories

QuickSet plus

- Article number: 9070532
[Details ▶ www.theben.de](http://www.theben.de)



clic

- Article number: 9070515
[Details ▶ www.theben.de](http://www.theben.de)



QuickSafe

- Article number: 9070531
[Details ▶ www.theben.de](http://www.theben.de)



Surface frame compact

- Article number: 9070514
[Details ▶ www.theben.de](http://www.theben.de)

